

Precinct Vision & Principles

The Macmillan Precinct is Victoria Park's shared commons, where culture, community and creativity intertwine.

Welcoming community facilities and events, immersive green spaces and an eclectic mix of uses shape a unique destination that is deeply connected to its history while boldly embracing a new future.

Green Forever



The Macmillan Precinct will remain a focal green space, both a relaxing retreat from inner city life and a dynamic stage for unique experiences and major events.

Space for All



The Macmillan Precinct will become the heart of East Vic Park, a place of community wellness and belonging that sustains the Town's valued services through flexible design.

Mixed Together



The Macmillan Precinct will seamlessly connect with and complement Albany Highway's thriving entertainment scene, retail core and public transport linkages.

Local Character



The Macmillan Precinct will re-imagine the 'civic precinct' and evolve into an energetic local hub that embodies East Vic Park's unique identity and character.

5.4 Concept Plan

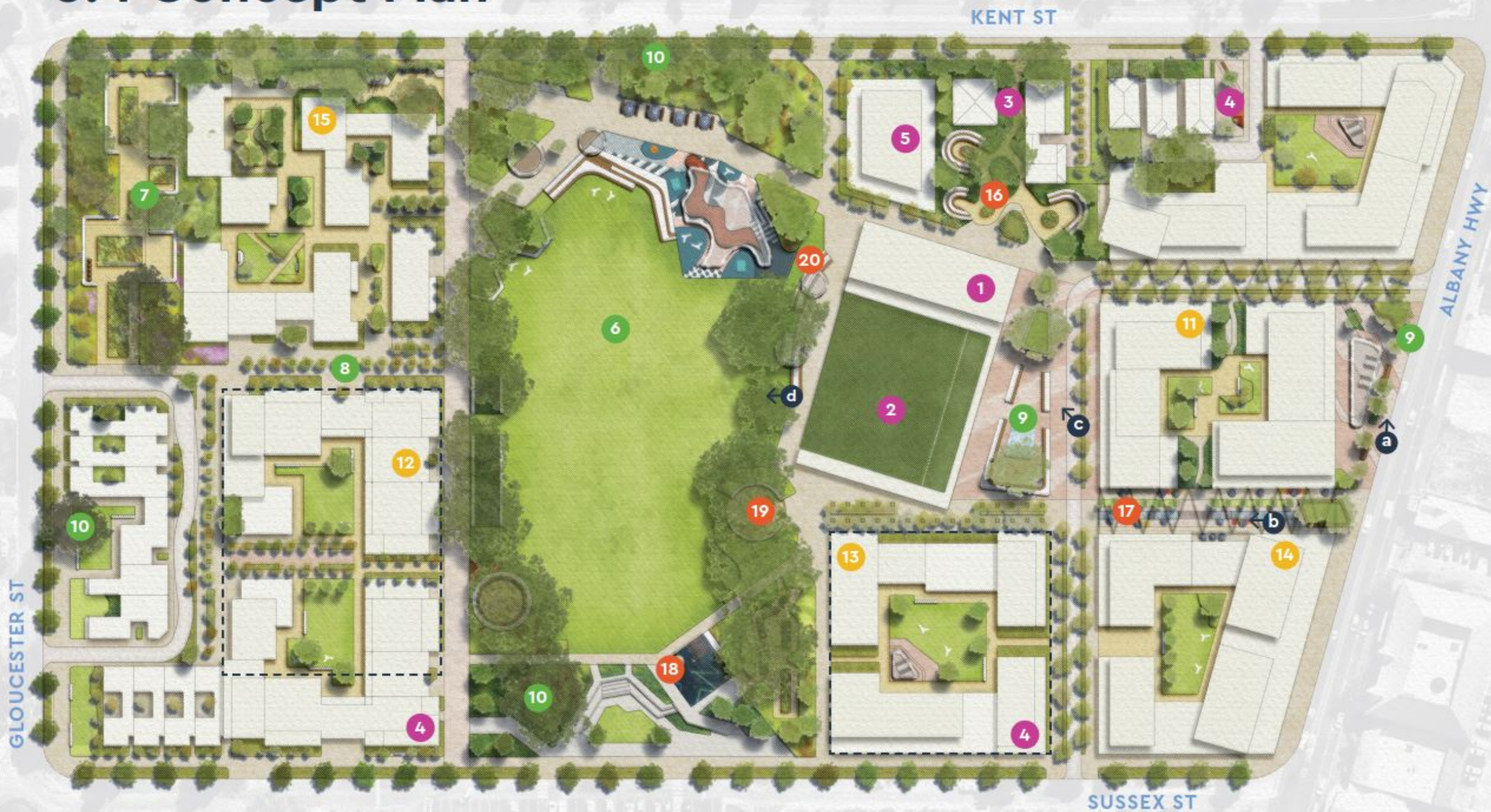

----- Alternative/expanded Community Hub and Bowls locations (refer pages 62 & 63).

 Concept Plan perspective views (refer pages 52-59).

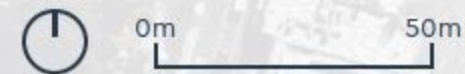

Facilities

- 1 Combined community hub including expanded Leisurelife and Library and community centre spaces. Facility design subject to further consultation.*
- 2 Opportunity for unique rooftop bowls integrated with community hub. Other locations subject to consultation with Bowls members.
- 3 Expanded Arts Centre with increased studio, exhibition and performance space.
- 4 Potential locations for non-profit facilities including Childcare and Sussex St Law Centre, subject to consultation with operators.
- 5 Future-ready space for additional community services as demand rises.

Public Space

- 6 Expanded John Macmillan Park with seating, lighting, native landscaping, promenades and a destination playground
- 7 Gloucester Street pocket park with retained trees and quiet sensory garden spaces
- 8 Landscaped green links providing pedestrian and cyclist connections through the site
- 9 Hardscaped public piazza space for informal public events and to support wayfinding into the precinct
- 10 Retained and protected mature figs and gums

Other Uses

- 11 Potential for non-profit office and service spaces which complement and extends Town services
- 12 Long-term ground lease opportunities e.g. Aged Care which provide ongoing revenue to help fund Town services
- 13 Parkside cafes with outdoor seating and space for parents to watch kids play in the park
- 14 Ground floor workshops, artist studios, cafes and small retail tenancies which complement Albany Hwy traders
- 15 Opportunities for sustainable and innovative demonstration housing

Placemaking

- 16 Sculpture garden and outdoor 'culture courtyard' utilised for arts classes and events
- 17 Laneway network with active ground floor tenancies and creative workshops/studios, public art and suspended feature lighting
- 18 Expanded youth hangout space with improved lighting and kick-about space
- 19 Yarning Circle and traditional owner storytelling and recognition throughout public spaces
- 20 Fixed screen of outdoor movies and cultural programming

*Containing Library & community space, Leisurelife facilities and potentially Bowling Greens. Several design options to be explored through detailed masterplanning and further community consultation.