



TOWN OF VICTORIA PARK
Received: 04/02/2022

Attachment 3

Waste Management Plan



TOWN OF VICTORIA PARK
Received: 04/02/2022

The Blasta Group Pty Ltd

Waste Management Plan

98-106 Goodwood Parade Burswood 6100



Contents

TOWN OF VICTORIA PARK
Received: 04/02/2022

Introduction	3
Subject Site	3
Waste Considerations	3
Waste Recycling	4
Food Donations	
Local Sourcing	4
Renewable Energy	5
Efficient Energy	5
Packaged products	5
Site Waste Generation	6
Site Waste Removal	7
Waste Management Policy	10
Internal & External	11
Principles	11
Outcomes	11
Function & Delegation	11
Policy Implementation	12
Risk Management	12
Energy Reduction	13
Waste Minimisation	14
Waste Storage	14
Waste Disposal	15
Waste Management Procedure	16
Considerations	16
Procedure Steps	17
General Waste	17
Recycling	17
Brewery Waste	18
Hazardous Waste	19
References	21
Internal	21
External	21
Resources	22

Introduction

Blasta Brewing Company is a competent beer manufacturer and reliable hospitality operator who strongly recognises the environmental impacts of its operations. Its business and employees are actively and continually searching for innovative ways to reduce the environmental impact in all aspects of its operations. Blasta is a leader in its field on using leading environmentally focused circular waste initiatives and utilises several approaches throughout its business.

Direct waste and the management of this waste forms a strong backbone for sustainability initiatives and achieving the environmental goals of the business.

Subject Site

The subject site is described as Lots 5 (No.98) 4 (No.100), 3 (No.102), 2 (No.104), 1 (No.106), Goodwood Parade, Burswood. The existing use of the subject site is mixed consisting of vacant land at 90-100 and existing use of “Warehouse / Light Industrial at 102-104 ”.

Blasta Brewing Company propose to change the use to ‘Brewery’ and ‘Restaurant/Café’. The total service area of the sit down eating and drinking area will make up 731 m² and the Brewery production components of 160 m².

Waste Considerations

Waste can affect different aspects of the environment and may cause contamination, impacts on visual amenity and health effects. Waste materials that may be produced on the subject site include:

- Litter including food and drink packaging from restaurant, bar, café, and brewery operations
- General Waste from patrons
- Recyclable waste from patrons
- Maintenance works waste
- Office equipment paper, cardboard from packaging, etc.; and it is important that all litter and waste generated by maintenance activities is constrained within the subject site, using designated bins and waste management procedures. At no time should surrounding premises or environments will be impacted by waste from maintenance or construction.

The creation of waste and the disposal of waste can have a significant impact on the environment for number of reasons, including:

- Resources, materials, and energy used to produce, package and transport products are lost when products are disposed to landfill.

- Landfills take up large amounts of land and can be noisy, odorous, and unsightly. Landfills (and
-
- the land surrounding them) are likely to become alienated land for many years into the future.
- Waste materials in landfill can take from months to hundreds of years to break down, or may not break down at all, meaning the environmental impacts of landfills will last for generations.
- The breakdown of waste within landfill can create pollutants and toxins which can contaminate groundwater, surface water and the atmosphere.
- Transport associated with the collection of waste creates greenhouse gas emissions and other air pollutants. Efficiencies in reducing transport costs will have a positive environmental impact by reducing greenhouse gas emissions and air pollutants.

Blasta Brewing Company strives to reduce, reuse, and recycle waste before finally disposing of any remaining non-recycle and hazardous wastes in a responsible way. The company is committed to forming strategic partnerships to achieve strong mutual outcomes for stakeholders, the environment, and the community.

Waste Hierarchy of Control

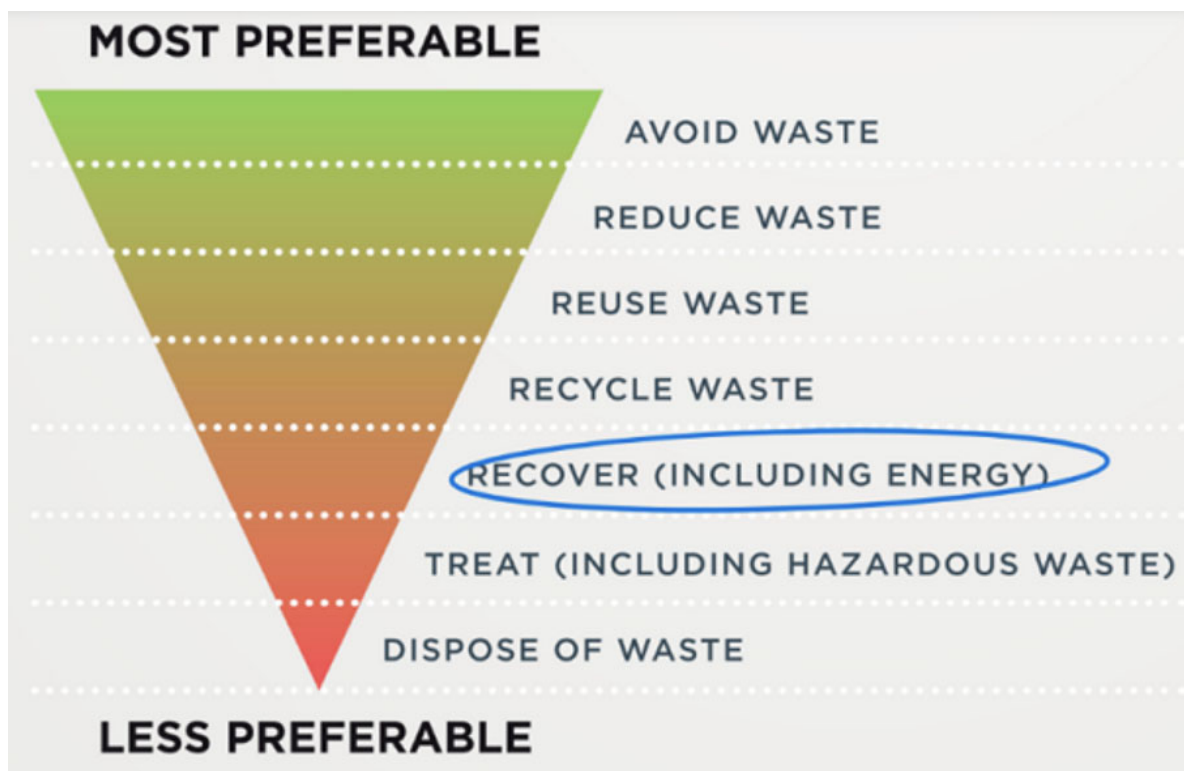

Waste Recycling

The guiding principle of waste management is to minimise the impact of waste on the environment and the public wherever practicable. The hierarchy of waste management applied is a) Avoid – making the waste in the first place – alternative designs & lean procurement systems. b) Reduce – via prevention or elimination of waste products; c) Reuse – find a secondary use for the waste product; and d) Recycle – alternative use for waste product which may include reprocessing of product. e) Recovery – divert materials away from landfill that can be processed into feedstock for the waste to energy sector. f) Landfill – control the destination of waste to its' relevant class of landfill site.

Food Donations

Any quality food waste will be donated to local food banks and charity organisations. Food programs such as this are essential in protecting Perth's most vulnerable citizens.

Locally Sourced Foods

Blasta Brewing Company supports local businesses and suppliers in Perth and wants to showcase the very best of local produce. The team will endeavor to source as much local, fresh, and organic food stuffs as possible. The menus will also be seasonal to support these efforts.

Renewable energy

Blasta Brewing Company has committed to invest in renewable energy as soon as the business is steady and viable. The company would like to invest in solar energy. The positive environmental impact as well as the cost savings are well justified. Several breweries throughout Australia are run on 100% renewable energy with great support from the community and their patrons.

Efficient Energy

The site will use energy efficient equipment and lighting including the use of LED globes throughout the venue. The team will take into consideration the energy efficiency rating of equipment at the design/ purchase stage.

Packaged Products

Blasta Brewing Company will ensure its packaging is environmentally sustainable, paper packaging will be from recycled stock and the output of the brewery to authorised liquor merchants will be in 50 litre re-usable kegs or aluminum cans only

Site Waste Generation

The following table details the waste generated by operational area along with quantity and frequency of collection required based on projections.

Blasta proposes to commit to one extra general and recycle bin to accommodate for peaks in demand to ensure there are no adverse effects with under capacity.

Waste Type	Floor Area	Days Of Operation	Waste Generation	Frequency of collections	Reqd Waste Storage capacity	No & Size of Bins provided
General Waste	731m ²	7	50L:100SQM	Daily	365L	2 x 660L General Waste bins
Recycle waste	731m ²	7	50L:100SQM	Daily	365L	2 x 660L Recycle Waste bins
Brewery Waste	160m ²	4	250L Per brew	Daily	1000L	4 x 660L Brewery bins

General and Recyclable waste is to be collected from the south of the subject site which is accessed from Stiles Avenue.

The waste generated will be more than that which can be collected by the local government and will be contracted to a licenced external third party. Waste for council collection shall be stored in vessels of size which their vehicles can readily collect and on a day of their choosing.

Bins shall be stored within the waste storage area at the rear of the building with appropriate wash down facilities.

Waste Collection Area

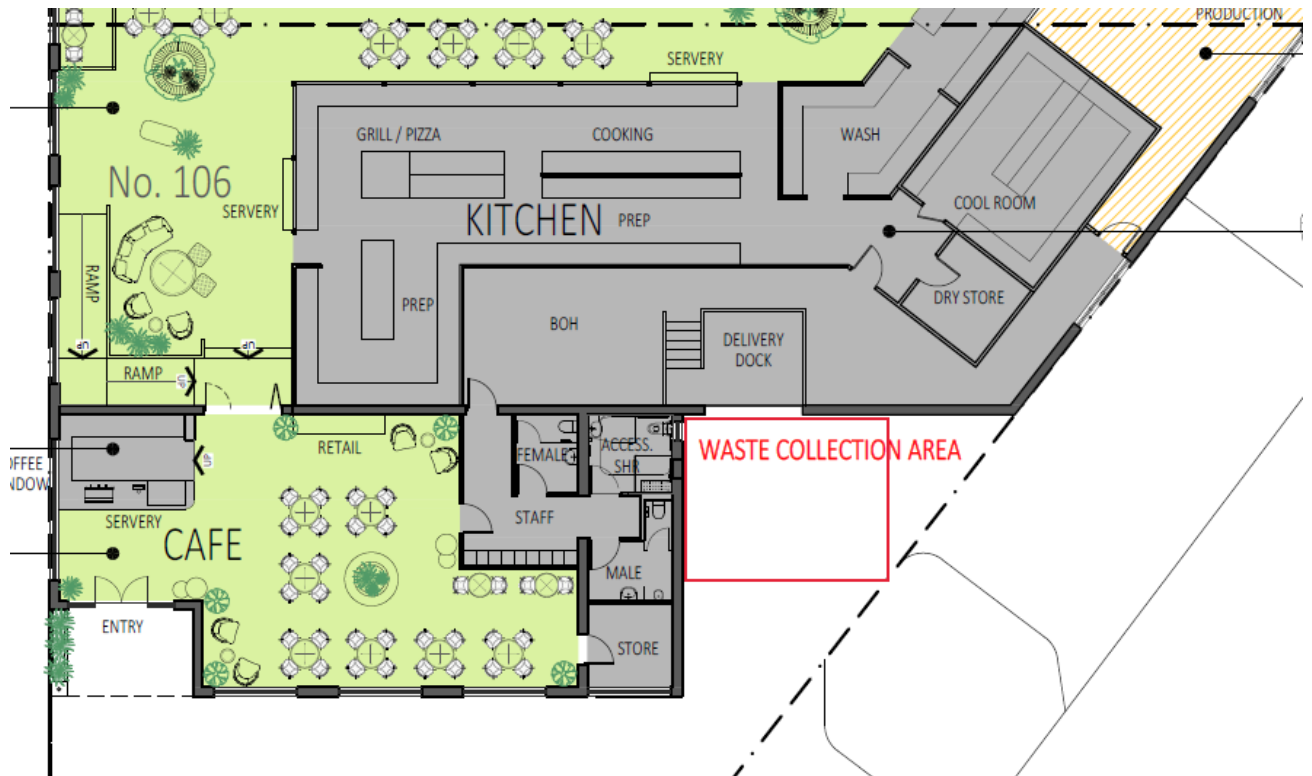

This waste collection area is suitable and capable of securely and discreetly storing, sorting, and removing the waste stream from the business.

Having direct access for the waste contractor and local weekly government bin collection allows for efficient and screened waste collection.

Site Waste Removal

The removal of waste from the subject site will be conducted from the South - southeast side of the Lot 1 (106 Goodwood Parade) adjacent to Stiles Avenue. The area is ideal due to clear access of the entire operations from the loading dock area which will serve as the service corridor for all deliveries and resulting waste streams. Staff will be responsible for the collection and disposal of site waste in accordance with business procedures.

It is proposed to utilise the existing loading dock area and clear access way which also allows for screening of the BOH Waste streams from the Stiles Griffiths reserve and laneway 133A which is earmarked for imminent redevelopment. This is the location we will receive deliveries and the pickup point for waste collection.

Waste shall be collected by an approved waste collection provider by way of waste truck to empty waste bins. Pick up shall be direct access from Stiles Avenue.

The proposal is in accordance with the standard sizing for a service vehicle as per the Austroads 2013 Design Vehicles and Turning Path Template.

Access Area

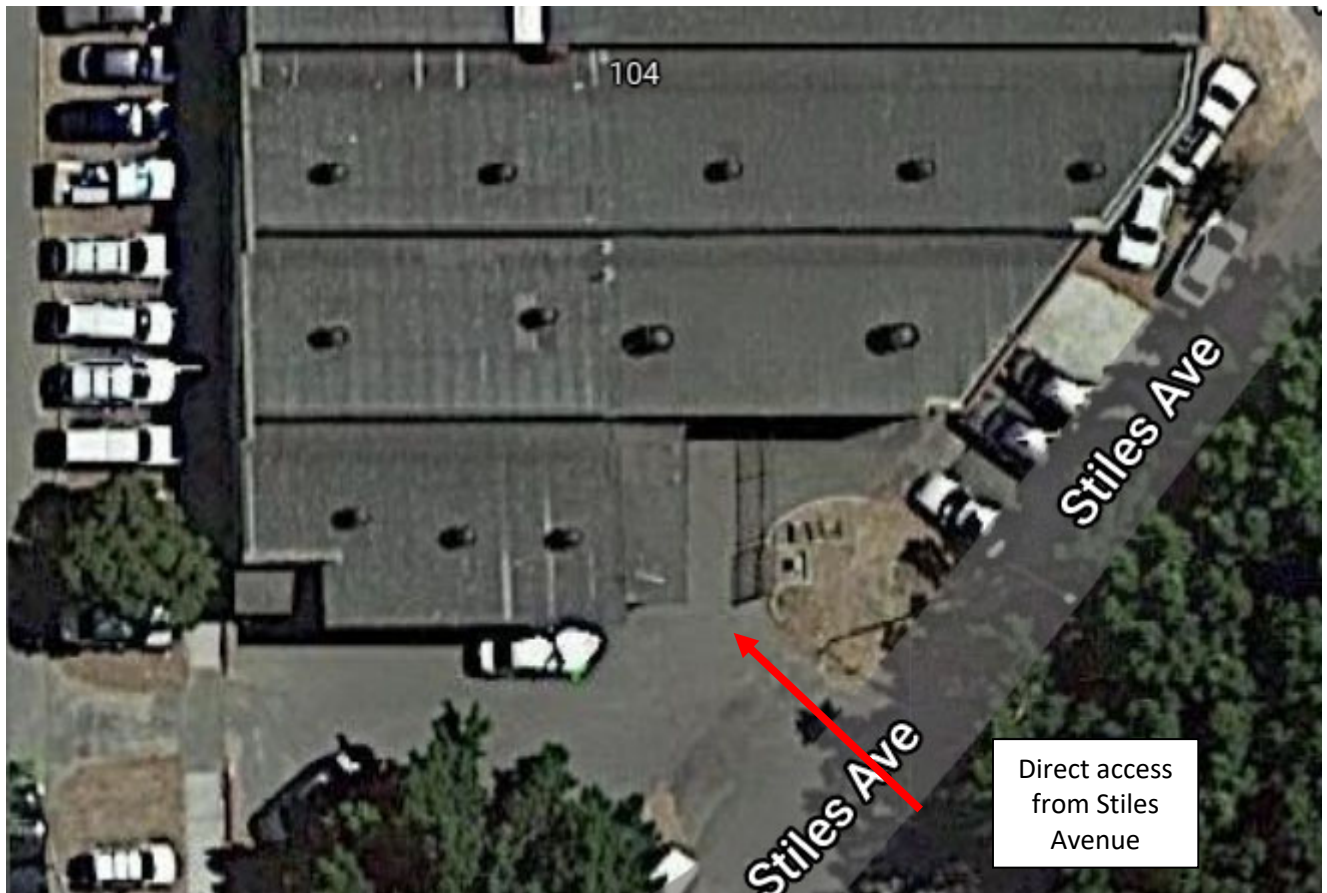

The venue is designed to create minimal unnecessary waste, with food ingredients ordered at responsible and sustainable levels.

The largest amount of potential waste will be from the brewing process where there will be spent grains. These grains have been recycled throughout the world and are commonly used a food source for local farms. Blasta Brewing Company will donate all the spent grains to local farmers to feed their stock.

Grain waste from the subject site will be collected regularly and within 12 hours of creation. Collection would entail a small truck driving up to the waste area to be loaded and having grain bins placed onto their load. The bins would be returned early the next day.

Kitchen waste will be collected daily in the early mornings, should demand warrant it an additional service on Friday mornings could be facilitated. Kitchen waste will be stored in an appropriate area and vessel which will ensure it meets all environmental health and safety requirements. There will be wash down facilities provided within the contained bin storage area. The bin area will be washed down after each time of collection

Water waste will be at an appropriate standard for discharge into sewerage, grease traps will be utilised for both the kitchen, brewery operations and waste wash down area.

Waste Management Policy

Blasta Brewing Company will adopt a waste management policy that is stringent and aligns with their ethos to reduce as much waste as possible and have consideration to the environment in terms of waste generation, disposal, re use, recycle and removal.

Policy

Internal

- Occupational Health and Safety Policy
- Pest Control Policy
- Waste Management Procedure

External

Legislation and local government

- Health Act 1911 (Health Department of Western Australia)
- Waste Avoidance and Resource Recovery Act 2007 (Department of Environment Regulation) Version 2015

Brewing Industry

- Solid Waste Reduction Manual (Brewers Association)
- Water and Wastewater: Treatment/Volume Reduction Manual (Brewers Association)
- Energy Usage, GHG Reduction, Efficiency and Load Management Manual (Brewers Association)
- WA Waste Authority: <http://www.wasteauthority.wa.gov.au/>
- Australian Government Department of Environment, 2010, National Waste Policy

Definitions

Waste separation is the process of separating waste at the point of generation and keeping types of waste separate during handling, accumulation, interim storage, and transportation.

Types of Waste

- **General waste** is any waste that is not classified as chemical or related waste. It includes organics and non-recyclable goods.
- **Recyclable waste** is waste that is to be separated and collected for recycling includes paper, plastic, glass, cardboard
- **Brewing waste** is waste generated through the brewing process primarily spent grain and other reusable organic by-products.
- **Liquid waste** is generated as a liquid including as a result of wash down, cooking, cleaning and use of oils.
- **Hazardous waste** includes chemical waste and related waste.

Waste management is the collection, transport, processing, recycling, or disposal, and monitoring of waste materials. The term usually relates to materials produced by human activity, and it is undertaken to reduce the effects of waste on health, the environment or aesthetics and to recover resources through recycling.

Principles

A range of waste management strategies are undertaken by Blasta Brewing Company to create a safe, secure, and environmentally friendly atmosphere.

The prevention and minimisation of waste material being created is an important method of waste management.

Outcomes

Maximise conservation of natural resources and minimises environmental harm through an effective waste management system of recycling and reusing waste products wherever possible.

Blasta Brewing Company actively promotes the use of effective waste management strategies and waste is disposed of safely in a way that least harms the environment.

All staff are supported and encouraged to participate in waste management

Position	Delegation/Task
Directors	Endorse Waste Management Policy. Compliance with Waste Management Policy.
Management	<p>Compliance with Waste Management Policy. Venue Manager</p> <p>Ensure Waste Management Policy aligns with Occupational Health and Safety and Infection Control Policies.</p> <p>Establish and implement systems for waste management.</p> <p>Ensure waste management policies and procedures are effectively implemented.</p>
Staff	Compliance with Waste Management Policy.

Policy Implementation

Responsible waste management is a shared, day-to-day responsibility. Mechanisms are in place to monitor implementation of this policy.

This policy applies to all staff, external waste contractors and suppliers of Blasta Brewing Company. Removal of waste from the premises includes general waste, paper and cardboard, redundant furniture and fittings, and ink printer cartridges.

Risk Management

Risks involved with waste management are regularly assessed, identified, and managed.



Employees are trained in waste management, including becoming familiar with types of waste and appropriate, safe handling and disposal methods.

Personal protective equipment is accessible available as required.

TOWN OF VICTORIA PARK
Received: 04/02/2022

Blasta Brewing Company acknowledges that different materials require a different waste management approach and investigates appropriate avenues for disposal, particularly where waste may be dangerous and/or hazardous.

Energy Reduction

All staff will reduce consumption, conserve energy, reduce fossil fuel consumption, and reduce air pollution through strategies such as:

Preventing the need to use energy

- Natural lighting in the roof to reduce the need for artificial lighting
- Utilising efficient brewing processes
- Making sure equipment is the right size for the job.

Minimising use

- Minimising expenditure on space heating
- Turning off lights and equipment when not operating.

Efficient equipment, lighting, heating, and vehicles

- Using energy efficient office equipment and power saving functions
- Using the most efficient motor vehicles
- Using the most efficient lights –where possible

Reducing Greenhouse Gas

- Installation of 40KW solar system capable of providing 80% of required site energy
- Review options for other renewable energy sources

Purchasing Considerations

- Purchasing items with reusable, recyclable, or no packaging
- Requiring suppliers to quote the energy consumption and costs of new equipment

Waste Minimisation

All staff minimise waste through strategies such as:

Reducing waste

- Quantifying the waste produced
- Examining each work process steps to determine where wastes are produced and to devise measures for waste prevention or reduction
- Partnering with a waste management contractor to assist with waste minimisation
- Keeping a running tally of waste production to track changes and improvement
- Responsible ordering of perishable foods
- Deep fryers or similar oil heavy appliances should be avoided where possible

Reusing

- Reusing drums, cartridges, and containers where possible.
- Selling or donating waste to other organisations including:
- Partnering with local charities to donate unused perishable food to those in need
- Brewing waste shall be reused 100% as stock feed
- Appropriate meat offcuts reused by staff for pet food

Increasing recycling

- Investigating alternative uses for organic waste that cannot be reduced or reused,
- Segregating wastes to aid recycling and provide an indication of why waste is forming
- Diverting recyclable wastes from the general waste

Waste Storage

Blasta Brewing Company shall store all waste in appropriate containers and locations, all waste disposal vessels shall be appropriately and marked.

- **General waste** shall adhere to 50L per 100m² of bar area/ day and be stored in a bin room with wash down area/ facilities, ventilation, vermin prevention and control and water pollution prevention in the form of a grease trap.
- **Recyclable waste** shall adhere to 50L per 100m² of bar area/ day and be stored in a bin room with wash down area/ facilities, ventilation, vermin prevention and control and water pollution prevention in the form of a grease trap.
- **Brewing waste** shall be only stored short term to be disposed of within 24hrs of generation and shall be stored within 1000L bins.
- **Liquid waste** when required to be stored shall be done so in a safe designated area. Oils shall be stored in a direct connected spent oil collection tank from any deep fryers or similar appliances.

Blasta Brewing Company shall have

- 1700 litres of available general waste bins
- 2300 litres of available recyclable waste bins
- 4640 litres of available spent grain bins

Waste Disposal

Employees will dispose of waste in accordance with the Waste Management Procedure. Waste disposal will be undertaken by the council service and / or local waste disposal business.

- **General waste** handled with appropriate care and disposed of at regular intervals.
- **Recyclable waste** handled with appropriate care and disposed of at regular intervals.
- **Liquid Waste** shall be treated appropriately prior to discharge to the sewerage; the sewerage connection shall have water pollution prevention in the form of a grease trap. Oil shall be collected for recycling.
- **Brewing waste** shall be collected within 24 hours of being created and shall be taken for reuse as stockfeed.
- **Hazardous waste** handled by trained personnel using appropriate personal protective equipment.

Waste Management Procedure

TOWN OF VICTORIA PARK
Received: 04/02/2022

The waste management procedure provides guidance and expectations for all employees of Blasta Brewing Company. The procedure outlines the methods and guidance for the collection and disposal of the waste from the business which includes but is not limited to all waste from the restaurant, Brewery, and office.

All employees of Blasta Brewing Company are responsible for complying with this procedure to ensure the safe and effective management of waste from the business. This procedure is governed by the Waste Management Policy.

Considerations

Blasta Brewing Company is fully committed to recycling and reusing waste products wherever possible to enable an effective waste management system that maximises conservation of natural resources and minimises environmental harm.

Blasta Brewing Company recognises that different waste streams require a different waste management approach, and as such, will utilise different waste receptacles based on the waste product.

6 x Bins

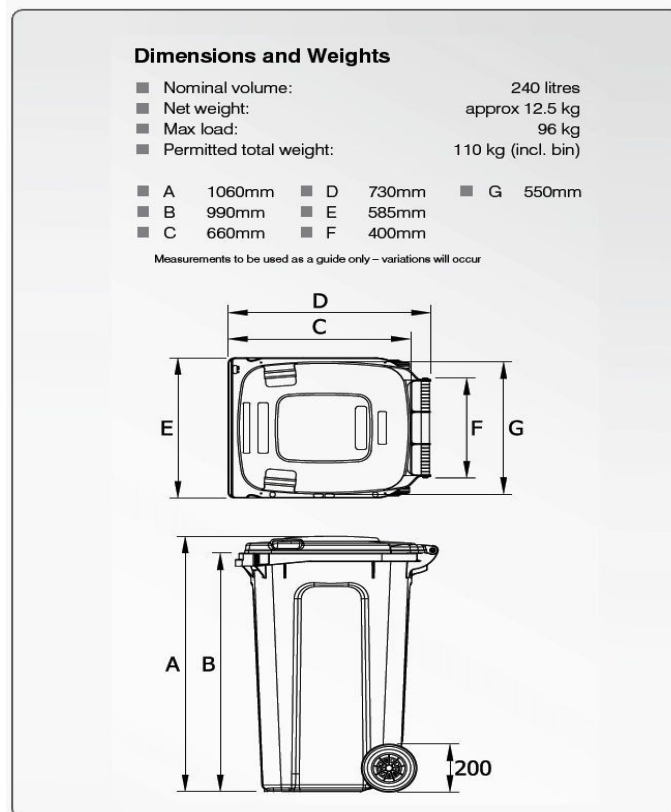

3 x Bins

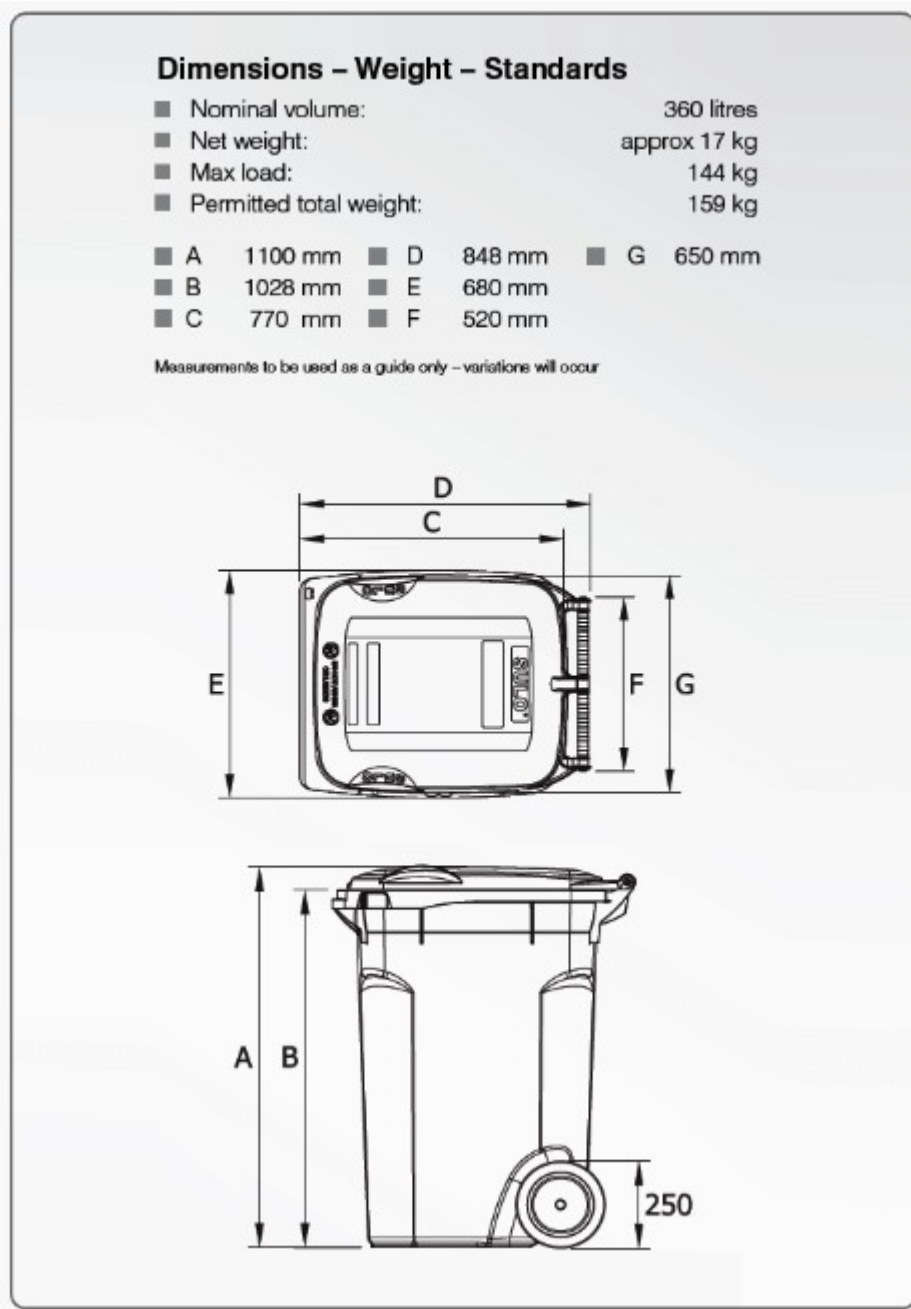

1200 litre capacity total on two wheeled bins

4 X Bins

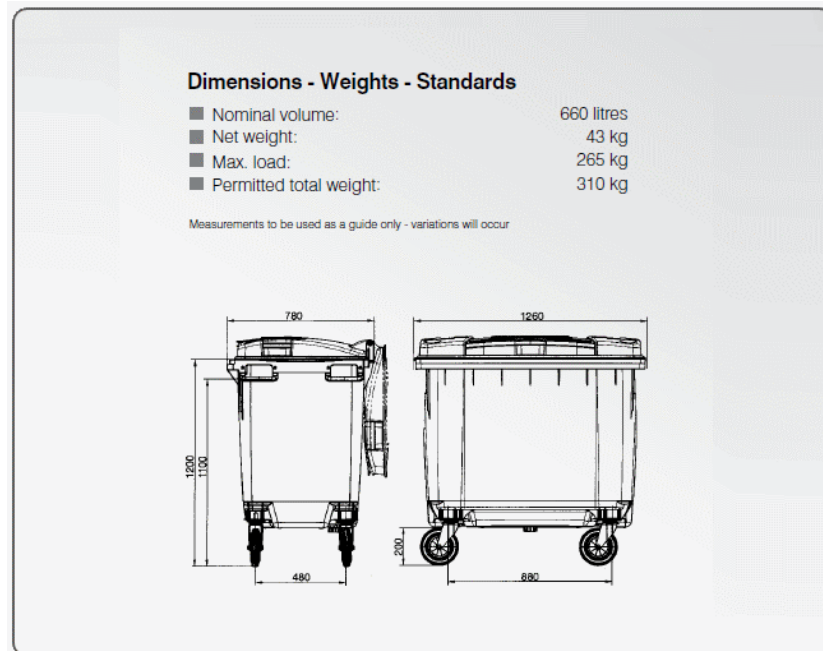

1240 capacity on 4-wheel bins

Total bin capacity = 4880 litres

Procedure Steps

TOWN OF VICTORIA PARK
Received: 04/02/2022

General Waste

1. Rubbish bins for waste other than recyclables are provided on the premises in the kitchen, brewery and the restaurant/ bar area. All waste will be emptied by staff regularly, with a minimum of daily.
2. Employees will ensure all rubbish is placed in thick commercial grade bin bags prior to placement in the large bins in the waste storage area.
3. Employees will not overfill bags to ensure their personal or others health and safety as well as that of the venue.
4. Bins are not filled to their approved levels and all lids must be able to close to ensure the health and safety of all stakeholders.
5. Local government waste must be wheeled to the verge to the front of the building on the south side of the building onto the boundary with Stiles Avenue. Once emptied the bins are to be taken in immediately for wash down, drying and reuse.
6. Waste generated more than that which can be collected by the local government will be contracted to a licenced external third party. Waste for council collection shall be stored in vessels of size which their vehicles can readily collect

Recycling

- I. Designated recycling bins shall be appropriately marked, and large bins must feature a yellow lid to indicate its contents easily.
- II. Receptacles for wastepaper are provided on the premises in offices or at workstations. These are emptied by the cleaners on a regular basis. If necessary, individual staff may empty wastepaper/cardboard into the larger recycling station located in the rear waste storage facility.
- III. Glass, plastic, and other recyclable materials should be placed directly in the recycling station.
- IV. Bins must be wheeled to the verge to the front of the building on the Northeast side so as not to encroach upon the disabled parking bay to the Northwest of the driveway.

Once emptied the bins are to be brought in immediately for wash down, drying and reuse.

- V. Waste generated more than that which can be collected by the local government will be contracted to a licenced external third party. Waste for council collection shall be stored in vessels of size which their vehicles can readily collect.

Brewery Waste

Brewery waste should be collected on the same day as generation or within 24 hours of production. The brewery is committed to ensuring high mash efficiency in their brewing process reducing the amount of malt used. Brewery waste is predominantly malt (and some hops) remaining from the mashing process which activates and extracts the sugars from the malt to create a wort for boiling, then, fermentation into beer. This waste is a 100% reusable by-product and can be consumed by humans and is an excellent feed option for farms.

Spent grain shall be emptied into large industrial bins which shall be moved via pallet jack or forklift. When empty the bins shall remain stacked in the waste storage area. While full the bins shall remain neatly in the brewery area until collection. The bins shall be open until the grain has cooled at which time the containers may have their lids attached. Full bins shall never be stacked more than two high.

Brewery waste shall be collected by vehicle reversing into the brewery area and having the grain loaded onto it via pallet jack or forklift. Full bins will go with the driver, while empty bins will be returned.

Brew waste container sizes: x 4

660 litres Dimensions: 1166 x 1166 x 809mm (L x W x H) - SOLID WITH LID



Capacity: 660 litres (0.66 tonnes)

Length: 1166mm

Width: 1166mm

Height: 809mm

2 x containers

TOWN OF VICTORIA PARK
Received: 04/02/2022

1000L Dimensions: 1180 x 1180 x 850mm (L x W x H)



Capacity: 1,000 Litres (220 gallons)

Length: 1180mm

Width: 1180mm

Height: 850mm

Weight: 55kg

Hazardous Waste

Hazardous Waste

All handling of hazardous waste is to be undertaken by qualified staff only using appropriate personal protective equipment. (PPE)

Blasta Brewing Company uses additional waste reduction strategies including the reuse of products, responsible ordering of food, repairing broken items instead of buying new, efficient brewing processes, community food programs, reusable products and forming strategic partnerships to better utilise waste and by-products’.

Reference Material

Internal

- Occupational Health and Safety Policy
- Pest Control Policy
- Waste Management Procedure
-

External

Legislation and local government



- Health Act 1911 (Health Department of Western Australia)
- Waste Avoidance and Resource Recovery Act 2007 (Department of Environment Regulation)

TOWN OF VICTORIA PARK
Received: 04/02/2022

Industry

- Brewers Association. Water and Wastewater: Treatment/Volume Reduction Manual
- Brewers Association. Energy Usage, GHG Reduction, Efficiency and Load Management Manual
- Brewers Association. Solid Waste Reduction Manual

Resources

- WA Waste Authority: <http://www.wasteauthority.wa.gov.au/>
- National Waste Policy Action Plan 2019
- Australian Government Department of Environment, 2010, National Waste Policy